



### Engine

Make and Model.....Caterpillar C15  
 Max Horsepower .....520 - 540 @ 2100 RPM  
 Max Torque..... 1314 FT-LB  
 Bore and Stroke..... 5.4016" X 6.7480"  
 No. of Cylinders.....6  
 Displacement..... 928 Cu/In (15.2 liters)  
 Optional Engine..... Cummins QSX15

### Air Cleaner

Donaldson - Two stage dry type with high efficiency pre cleaner.

### Electrical System

Type.....24 Volt Negative Ground/24 Volt Start  
 Alternator..... 24 Volt 95 AMP  
 Circuit Breakers..... Resettable Circuit Protection  
 Batteries (2)..... 12 Volt-8D @ 270 AMP Hr. each

### Torque Converter

Clark 8000

### Transmission

Clark 8000 Series Power Shift - Spur Gear; 4 Speeds Fwd and Rev.

Range	Ratio	Speed (Unladen)
1.....	4.07:1	3.5 mph (5.6 km/hr)
2.....	2.26:1	6.5 mph (10.4 km/hr)
3.....	1.29:1	11.0 mph (17.7 km/hr)
4.....	.71:1	18.0 mph (28.9 km/hr)

### Axles

Fabricated.....Allied Wagner  
 Make..... Clark  
 Model .....Industrial Planetary Axle - Heavy Planetary Rigid 25D  
 Type.....Planetary  
 Brakes ..... Wet Disc

### Tires

Size (Front).....(Dual) 24.00 x 35 (Bias)  
 Size (Rear) .....26.5 x 25 (Bias)  
 Optional .....Radial

### Hydraulic System

"Power Beyond" hydraulics with total capacity of all pumps in the system for multiple use simultaneously. Hydraulic pilot controls.

Steering Cylinder (2)..... 4" x 20" (102mm x 508mm)  
 Hoist Cylinder (2)..... 10" x 121" (254mm x 3073mm)  
 Tilt Cylinder (2) ..... 10" x 51" (254mm x 1295mm)  
 Holddown Cylinder (2)..... 8" x 56" (203mm x 1422mm)  
 Kickoff Cylinder (2) ..... 8" x 37" (203mm x 940mm)

### Service Refill Capacities

Fuel Tank..... 150 Gals (1609 liters)  
 Hydraulic Oil ..... 550 Gals (1325 liters)  
 Crankcase w/Filter..... 9 Gals (34 liters)  
 Cooling System ..... 12 Gals (91 liters)

## Purpose-Built Log Handlers



# L120

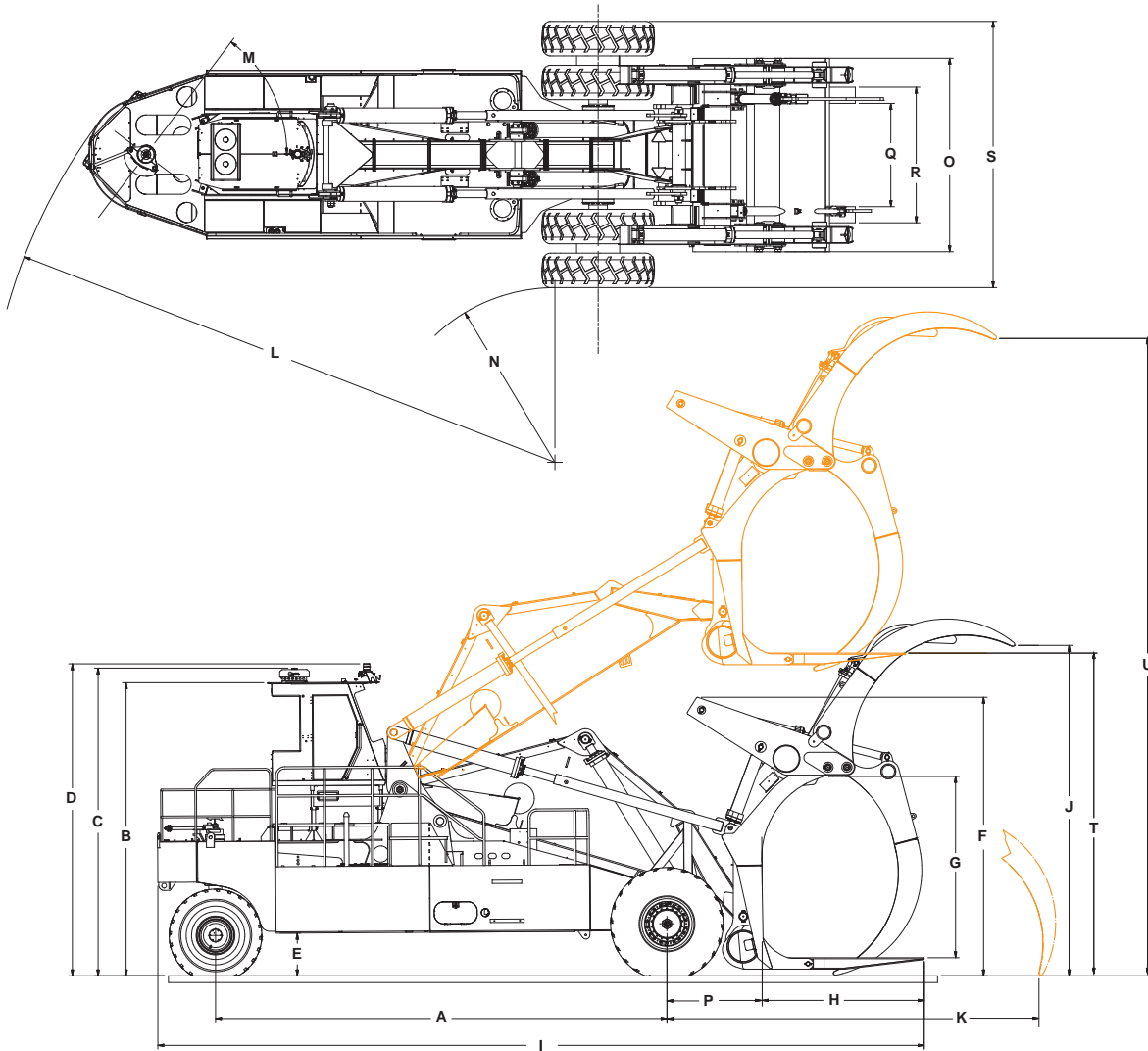

## Dimensions (approximate)

A. Wheelbase .....	28' 0" (8534mm)
B. Height to Top of Cab .....	18' 1" (5512mm)
C. Height to Top of AC Unit.....	19' 1" (5817mm)
D. Height to Top of Beacon.....	19' 4" (5893mm)
E. Ground Clearance Chassis.....	2' 8" (813mm)
F. Carriage Height.....	17' 3" (5258mm)
G. Mouth Opening .....	11' 3" (3429mm)
H. Tine Length .....	10' 1" (3073mm)
I. Overall Length .....	47' 6" (14478mm)
J. Ground to Holddown Tip	
Carriage Down/Holddown Up .....	20' 6" (6248mm)

## K. Distance from Axle to Holddown

Tip for Reach .....	24' 1" (7341mm)
L. Turning Radius Tail Swing .....	35' 3" (10744mm)
M. Swing Radius.....	53°
N. Inside Turning Radius .....	10' 10" (3302mm)
O. Carriage Width.....	12' 0" (3658mm)
P. Axle to Face of Carriage - Hoist Down .....	5' 11" (1803mm)
Q. Width Inside of Tines .....	6' 5" (1956mm)
R. Width Outside of Tines.....	8' 5" (2565mm)
S. Width Outside Chassis Tires.....	16' 5" (5029mm)
T. Ground to Fork - Hoist Up.....	20' 0" (6096mm)
U. Ground to Holddown Tip	
Carriage Up/Holddown Up.....	39' 4" (11989mm)

## Weights and Functions (approximate)

Unit Weight .....	180,000 lbs (81,646 kg)
Drive End.....	118,300 lbs (53,660 kg)
Tail End .....	58,900 lbs (26,716 kg)
Rated Lift Capacity 54" LC .....	120,000 lbs (54,431 kg)

Forward Tilt @ Ground Level .....	28°
Forward Tilt @ Max Height .....	20°
Backward Tilt @ Ground Level.....	22°
Backward Tilt @ Max Height .....	36°

# wagner

A Division of Allied Systems Company

21433 S.W. Oregon Street  
 Sherwood, Oregon 97140 USA  
 Telephone: 503.625.2560 • Fax: 503.625.7980  
 E-mail: [wagner@alliedsystems.com](mailto:wagner@alliedsystems.com)

[www.alliedsystems.com](http://www.alliedsystems.com)